

REVISIONS				
REV.	DESCRIPTION	ECN	DATE	APPROVED
F	REFER TO ECN	12840	8/26/2014	JJ

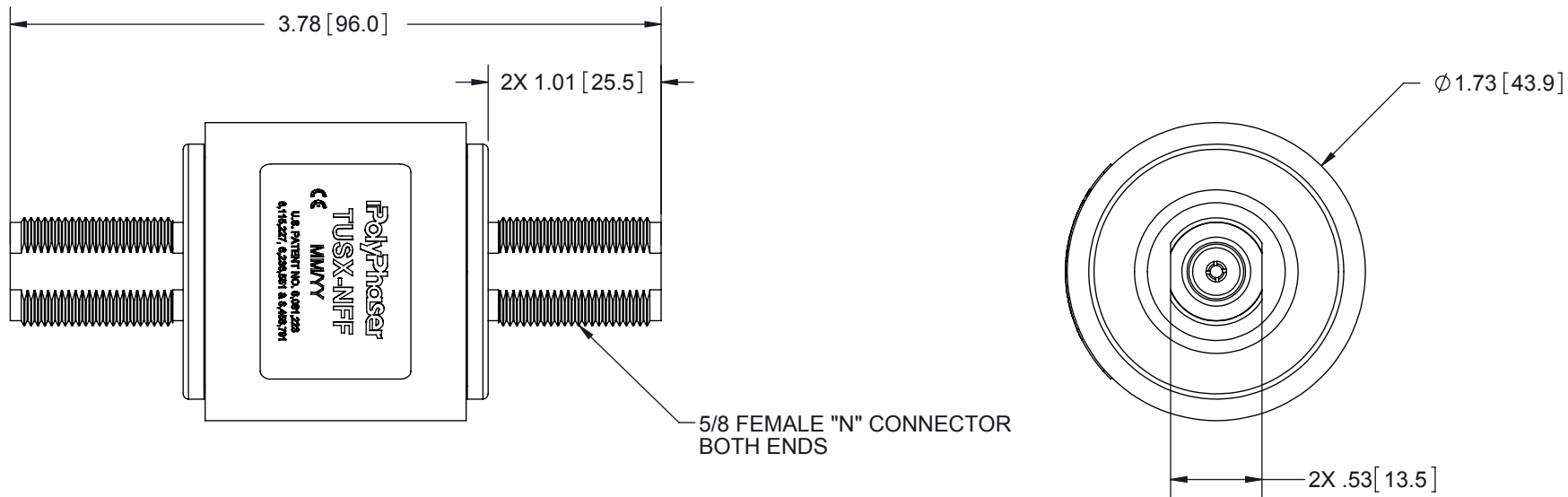

MAXIMUM CHARACTERISTICS

APPLICATION:
DC SHORT/RF ONLY (NO POWER SUPPLY PROVISIONS)
BULKHEAD MOUNT BI-DIRECTIONAL
WEATHERPROOF WHEN INSTALLED

FREQUENCY RANGE:

300MHz TO 1.2GHz

MAX SURGE:

IEC 61000-4-5 8/20µs WAVEFORM
20ka MULTIPLE STRIKES
40ka ONE TIME

INSERTION LOSS:

≤0.1dB

RETURN LOSS:

-26dB over FREQUENCY RANGE

CONTINUOUS POWER:

1kW @ 920MHz

2.5kW @ 400MHz

LET THROUGH VOLTAGE:

≤±500mV FOR 3kA @ 8/20µs WAVEFORM

THROUGHPUT ENERGY:

≤7.5nJ FOR 3kA @ 8/20µs WAVEFORM

TEMPERATURE:

-50°C TO +85°C STORAGE/OPERATING

VIBRATION:

1G @ 5Hz TO 100Hz

MATERIAL:

BODY: TRI-M3™ PLATING OVER BRASS

PTFE: DIELECTRIC

CENTER PINS: Au PLATED

ENVIRONMENTAL:

MEETS IEC 60529 IP67 WHEN CONNECTED

MEETS BELLCORE #TA-NWT-000487

PROCEDURE 4.11, 120MPH WIND DRIVEN

RAIN INTRUSION TEST

CE COMPLIANT

RoHS COMPLIANT

HARDWARE KIT	
QTY.	DESCRIPTION
1	NUT 5/8-24 303 HEX SS
1	WASHER 5/8 410 SS
1	SILICONE O-RING 019

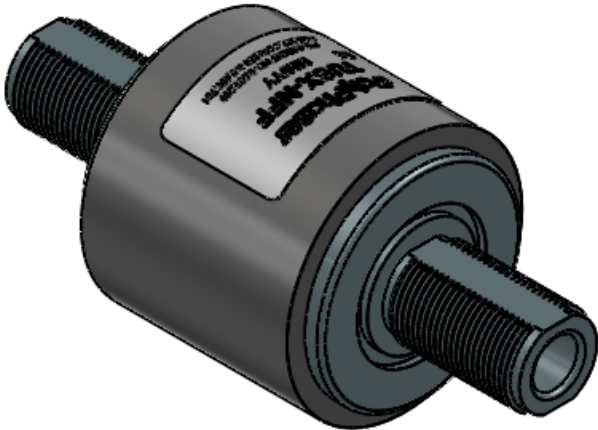

CUSTOMER APPROVAL: _____ DATE: _____

ALL DIMENSIONS SHOWN ARE FOR REFERENCE ONLY.

UNLESS OTHERWISE SPECIFIED LEADING DIMENSIONS ARE INCHES DIMENSIONS IN [] ARE MILLIMETERS TOLERANCES: FRACTIONS=± 1/32 .XX=± .03 ANGLES=± 1 ° .XXX=± .010		DRAWN RD	DATE 8/31/10			
		ENG APPD CAP	5/4/11			
		PRODUCT MGR SJD	5/5/11			
		MARKETING APPD		TITLE 300MHz to 1.2GHz UHF SX BI-DIR FEM 'N' CONN		
MATERIAL		PROJECT NO.		CUSTOMER SPECIFICATION		
				SIZE B	CAGE 30992	PART NUMBER TUSX-NFF
THIRD-ANGLE PROJECTION 		NOTICE: THE INFORMATION AND DESIGN IN THIS DOCUMENT IS THE PROPERTY OF TRANSECTOR SYSTEMS. ALL RIGHTS RESERVED.		SCALE 1:1	PROD CAT RFP	DOCUMENT NAME TUSX-NFF-C
				SHEET 1	OF 1	REV F

THESE COMMODITIES, TECHNOLOGY OR
SOFTWARE WERE EXPORTED FROM THE
UNITED STATES IN ACCORDANCE WITH THE
EXPORT ADMINISTRATION REGULATIONS.
DIVERSION CONTRARY TO U.S. LAW PROHIBITED.