

EPCOM

1630 Paisano Dr.
El Paso. Tx 79901.

Ph (915)533-5119
www.epcom.net

SYSCOM

Ave 20 de Noviembre No. 805 Col. Centro
Chihuahua, Chih. 31000 Tel 052 (614) 415 – 2525

www.syscom.mx

K29940603 PTT Side Key Rubber Button NX-200 & 300K Goma de Contacto Lateral del PTT

NX-200

PARTS LIST

* New Parts. Δ indicates safety critical components.

Parts without **Parts No.** are not supplied.

Les articles non mentionnés dans le **Parts No.** ne sont pas fournis.

Teile ohne **Parts No.** werden nicht geliefert.

L : Scandinavia

Y : PX (Far East, Hawaii)

Y : AAFES (Europe)

K : USA

T : England

X : Australia

P : Canada

E : Europe

M : Other Areas

NX-200 (Y50-6110-XX)

CONTROL UNIT (X53-4260-XX)

Ref. No.	Address	New parts	Parts No.	Description	Desti-nation	Ref. No.	Address	New parts	Parts No.	Description	Desti-nation
NX-200						68	2B		J99-0712-14	ADHESIVE SHEET (6KEY FPC)	
1	1B		A02-4002-23	PLASTIC CABINET (6KEY)	K	69	1A,2A		J99-0714-04	ADHESIVE SHEET (LCD)	
2	1A		A02-4003-23	PLASTIC CABINET (18KEY)	K2	70	3B		J99-0715-08	ADHESIVE SHEET (UNIVERSAL)	
3	3A	*	A10-4111-21	CHASSIS		72	3B		J99-0725-04	ADHESIVE SHEET (TERMINAL BLOCK)	
4	2B		A62-1156-02	PANEL (TOP)		75	3A	*	J99-0732-04	ADHESIVE SHEET (OP BOARD COVER)	
6	1B,1D		B09-0712-03	CAP ACCESSORY		77	3A		K25-2001-03	PUSH KNOB (PTT)	
7	1A		B11-1853-24	FILTER (LCD)		78	1A		K29-9405-03	KNOB (PTT)	
8	1A		B11-1854-02	ILLUMINATION GUIDE (LCD)		79	1A		K29-9406-03	BUTTON KNOB (SIDE KEY)	
9	3B		B11-1855-04	ILLUMINATION GUIDE (TX/BUSY)		80	1B		K29-9407-03	KNOB (VOL)	
10	1A		B38-0923-05	LCD ASSY		81	1B		K29-9408-13	KNOB (CH)	
12	1A		B42-7296-04	STICKER		A	1B,1D		N08-0564-04	DRESSED SCREW ACCESSORY	
13	1B		B43-1606-04	BADGE		B	3B		N09-2426-14	HEXAGON HEAD SCREW (BATT-)	
14	2D		B62-2014-10	INSTRUCTION MANUAL		C	3A		N09-2440-15	SPECIAL SCREW (CASE)	
17	2B		D32-0446-14	STOPPER (16CH)		D	2A,2B		N09-6549-04	STEPPED SCREW (FG-SP HOLDER)	
19	2A		E29-1220-04	RELAY HARDWARE (VCO-PCB)		E	2B,3A		N09-6554-05	PAN HEAD SCREW (ANT/OP BOARD)	
20	3A		E29-1221-14	RELAY HARDWARE (VCO-CHASSIS)		F	2B		N14-0844-04	CIRCULAR NUT (VOL,CH)	
21	3B		E58-0532-05	RECTANGULAR RECEPTACLE (SP/MIC)		G	1C		N30-3008-60	PAN HEAD MACHINE SCREW (BELT CLIP)	
22	3B		E72-0425-03	TERMINAL BLOCK		H	1A,2A,2B		N83-2005-48	PAN HEAD TAPTITE SCREW (PCB)	
24	3A		F07-1931-04	COVER (OP BOARD)		83	1A		S79-0472-05	KEYBOARD ASSY (12KEY)	K2
27	2A		G02-1836-13	EARTH SPRING (SP)		85	2A		T07-0755-15	SPEAKER	
28	1A		G10-1373-04	FIBROUS SHEET (SP)		86	2A		T91-0575-05	MIC ELEMENT	
29	2B		G10-1384-14	FIBROUS SHEET (TOP PANEL)		88	2A		W09-0971-05	LITHIUM CELL	
30	2A		G11-4272-14	RUBBER CUSHION (SP)		90	3A		X41-3710-10	SWITCH UNIT (PTT FPC)	
31	3A		G11-4331-04	SHEET (AIR)		91	2B		X41-3720-10	SWITCH UNIT (6KEY FPC)	
33	2A		G11-4428-04	SHEET (PTT)		92	2A		X42-3340-10	CORD ASSY (50PIN FPC)	
34	3A		G11-4429-04	RUBBER SHEET (FET)		93	2B		X60-3860-10	TERMINAL ASSY (SMA)	
35	3A		G11-4440-04	SHEET (AIR)							
36	2A		G11-4458-14	SHEET (SP)							

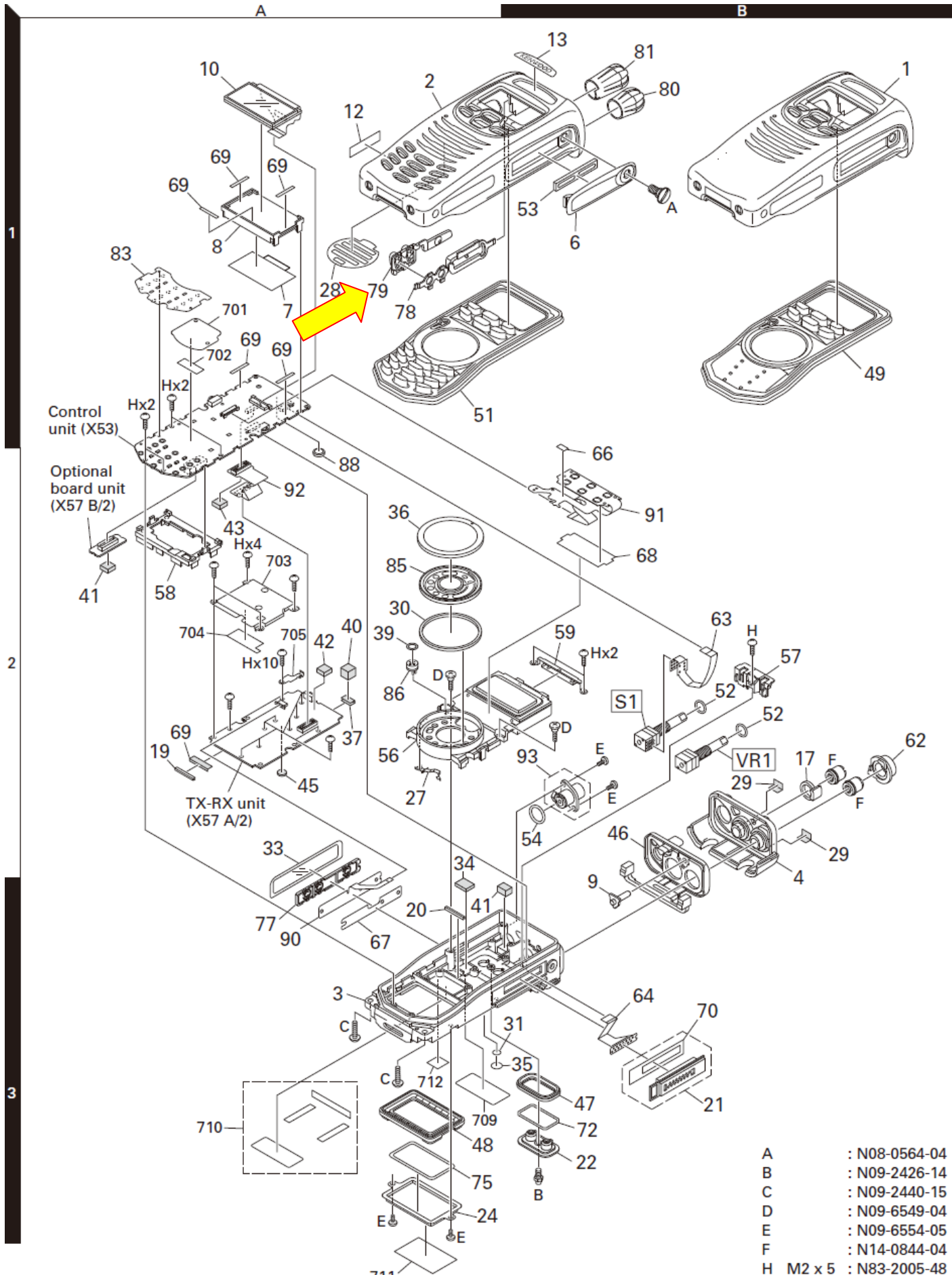

Control unit (X53)

Optional board unit (X57 B/2)

TX-RX unit (X57 A/2)

- A : N08-0564-04
- B : N09-2426-14
- C : N09-2440-15
- D : N09-6549-04
- E : N09-6554-05
- F : N14-0844-04
- H M2 x 5 : N83-2005-48