

THIS DRAWING CONTAINS INFORMATION PROPRIETARY TO RF INDUSTRIES.  
 ANY UNAUTHORIZED USE OF THIS DRAWING IS EXPRESSLY PROHIBITED  
 WITHOUT WRITTEN PERMISSION FROM RF INDUSTRIES.  
 ANY VIOLATION IS PUNISHABLE UNDER U.S. COPYRIGHT LAWS.

ALL DIMENSIONS ARE REFERENCE ONLY

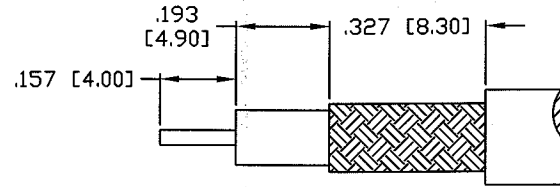

RECOMMENDED STRIPPING DIMENSIONS

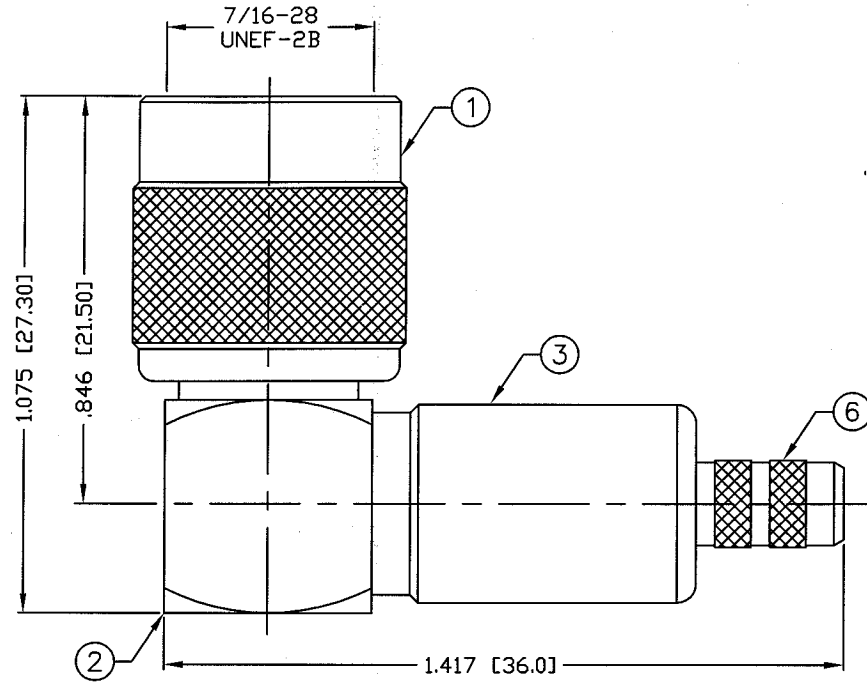
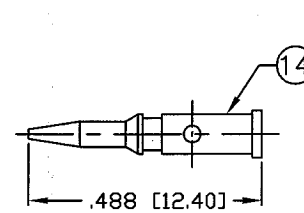

RECOMMENDED CRIMP DIE: .068

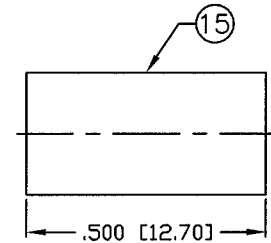

RECOMMENDED CRIMP DIE: .213

**SPECIFICATIONS:**

IMPEDANCE: 50 OHMS  
 FOR RG-58, 58A, 58C, 141, 141A, BELDEN 8240,  
 8259, 8262, 9201, 9203, 9310, 9311 & COMM/SCOPE 0268

1	BODY	1	BRASS	NICKEL, 100μ
2	PRESS BODY	1	BRASS	NICKEL, 100μ
3	FERRULE STUD	1	BRASS	NICKEL, 100μ
4	INSULATOR	1	PTFE	---
5	CONTACT	1	P. B.	GOLD, 3μ
6	INSULATOR	1	PTFE	---
7	GASKET	1	RUBBER	RED
8	RING	1	BRASS	NICKEL, 100μ
9	BUSHING	1	DELTRIN	---
10	PIN	1	BRASS	GOLD, 3μ
11	PIN	1	BRASS	GOLD, 3μ
12	WASHER	1	BRASS	NICKEL, 100μ
13	COVER	1	BRASS	NICKEL, 100μ
14	SHELL	1	BRASS	NICKEL, 100μ
15	FERRULE	1	COPPER	NICKEL, 100μ
#	DESCRIPTION	QTY	MATRL	FINISH (IN)

008974

UNLESS OTHERWISE SPECIFIED:

1. REMOVE ALL BURRS
2. BREAK ALL CORNERS & EDGES .005 R. MAX.
3. CHAMFER 1ST & LAST THREADS 45°
4. SURFACE ROUGHNESS 63 FINISH MIL-STD-10
5. DIAMETERS ON COMMON CENTERS TO BE CONCENTRIC WITHIN .002 T.I.R.
6. ALL DIMENSIONS ARE AFTER PLATING.

DIMENSIONS ARE IN INCHES AND [MILLIMETERS]

UNLESS OTHERWISE NOTED TOLERANCES ARE:

DECIMALS	DIAMETER
.xxx±.003 [.08]	.xxx±.001 [.03]
.xx±.005 [.13]	.xx±.003 [.08]

DRAWN	4/25/01
C. ZUNIGA	
CHECKED	ADM 4300
ORJ DRAWN	
K. MAXWELL	10/3/94
APPROVALS	DATE

**RF connectors**  
 DIVISION OF RF INDUSTRIES, LTD.

7610 MIRAMAR RD  
 SAN DIEGO, CA 92126  
 (858) 549-6340  
 (858) 549-6345 FAX

**TNC PLUG**

RIGHT ANGLE, CRIMP

SIZE	CABLE GROUP	DWG NO.	REV
A	C	RFT-1218	D
SCALE:	NTS	CAD FILE	OUTLINE
SHEET			1 OF 1