

## ■ Rear panel and connection

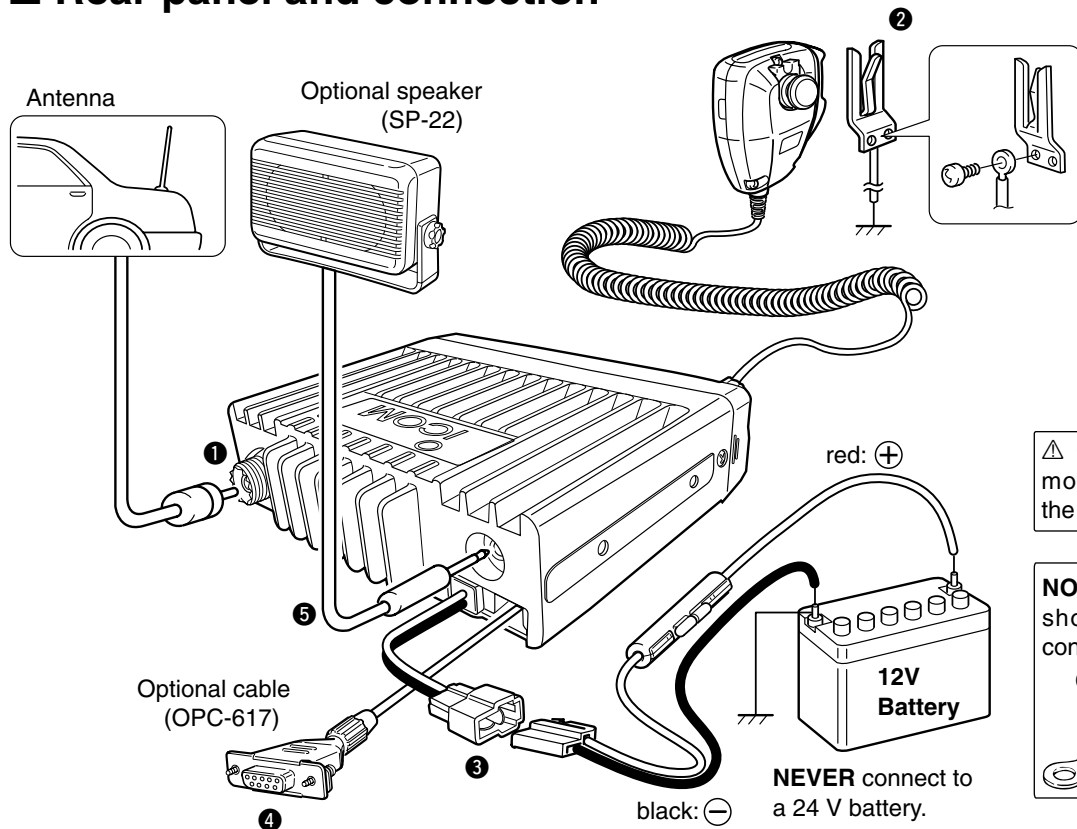

**IMPORTANT!** The microphone hanger connection is necessary to use the scanning function.

**CAUTION!** NEVER remove the fuse-holder from the DC power cable.

**NOTE:** Use the terminals as shown below for the cable connections.

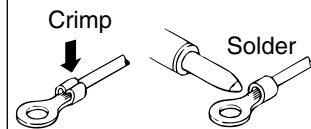

### ❶ ANTENNA CONNECTOR

Connects to an antenna. Contact your dealer about antenna selection and placement.

### ❷ MICROPHONE HANGER

Connect the supplied microphone hanger to the vehicle's ground for microphone on/off hook functions. (See p. 3)

#### /// **IMPORTANT!:**

The microphone hanger connection is necessary to use the scanning function. Scan starts when a microphone on hook.

### ❸ DC POWER RECEPTACLE

Connects to a **12 V DC** battery. Pay attention to polarities.

/// **NEVER** connect to a **24 V** battery. This could damage the transceiver.

### ❹ OPTIONAL CABLE (OPC-617)

Connect an external modem unit, dimmer control, etc.

### ❺ EXTERNAL SPEAKER JACK

Connect a 4–8  $\Omega$  (5 W) external speaker, if desired.

## ■ Mounting the transceiver

The universal mounting bracket supplied with your transceiver allows overhead mounting.

- Mount the transceiver securely with the 4 supplied screws to a thick surface which can support more than 1.5 kg.

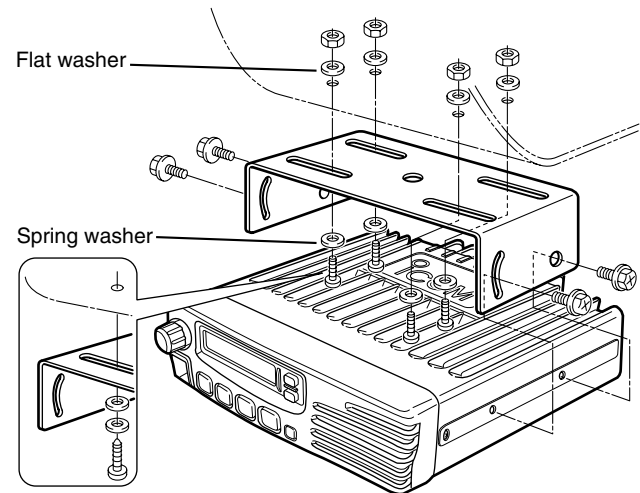

When using self-tapping screws

### ■ Optional UT-108 installation

Install the optional UT-108 unit as follows:

- ① Turn the power OFF, then disconnect the DC power cable.
- ② Unscrew the 4 cover screws, then remove the bottom cover.
- ③ Install the unit as shown in the diagram below.
- ④ Replace the bottom cover and screws, then re-connect the DC power cable.

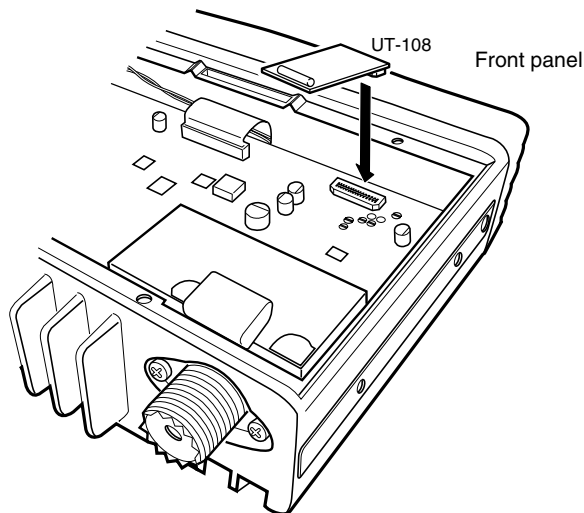

### ■ Optional UT-109 or UT-110 installation

- ① Turn the power OFF, then disconnect the DC power cable.
- ② Unscrew the 4 cover screws, then remove the bottom cover.
- ③ Cut the pattern on the PCB at the TX mic circuit (MIC) and RX AF circuit (DISC) as shown below.
- ④ Install the scrambler unit as described in the installation of optional UT-108 as on the page at left.
- ⑤ Replace the bottom cover and screws, then re-connect the DC power cable.

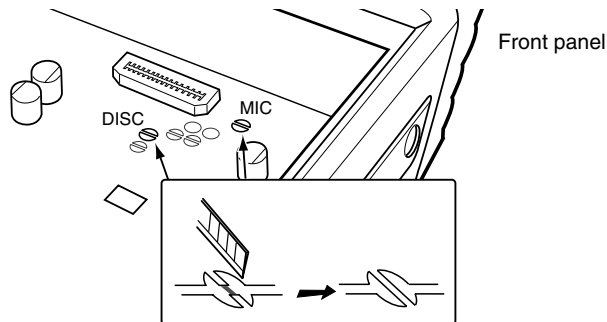

**NOTE:** Be sure to re-solder the above disconnected points when you remove the scrambler units. Otherwise no TX modulation or AF output is available.

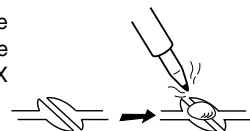

## ■ Optional OPC-617 installation

Install the OPC-617 as shown below.

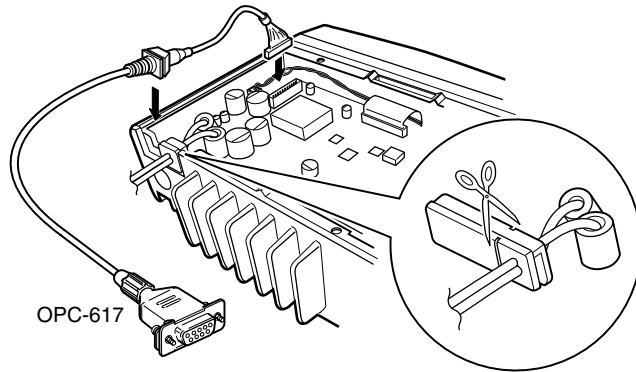

Cut off the bushing as in the illustration, when you install the optional OPC-617.

### OPTIONAL CABLE PIN ASSIGNMENT

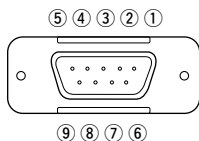

- |                                        |                        |
|----------------------------------------|------------------------|
| ① Dimmer cont. IN or<br>IGSW cont. IN  | ⑥ Horn drive cont. OUT |
| ② AF OUT                               | ⑦ AF GND               |
| ③ Det. AF OUT                          | ⑧ Det. AF GND          |
| ④ Mod. IN                              | ⑨ Mod. GND             |
| ⑤ PTT control IN or<br>FTSW control IN |                        |

## ■ Antenna

A key element in the performance of any communication system is an antenna. Contact your dealer about antennas and the best places to mount them.

## ■ Fuse replacement

A fuse is installed in the supplied DC power cable. If a fuse blows or the transceiver stops functioning, track down the source of the problem if possible, and replace the damaged fuse with a new rated one.

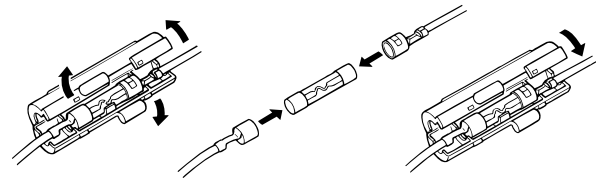

□ Fuse rating: 10 A

## ■ Cleaning

If the transceiver becomes dusty or dirty, wipe it clean with a soft, dry cloth.



**AVOID** the use of solvents such as benzene or alcohol, as they may damage the transceiver surfaces.